

1. BATTERY INSTALLATION | 电池安装

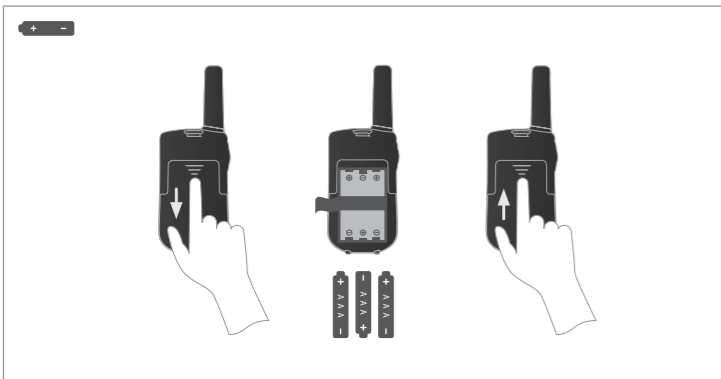

2. ON/OFF | 开/关



3. CHANGING CHANNEL | 更换频道

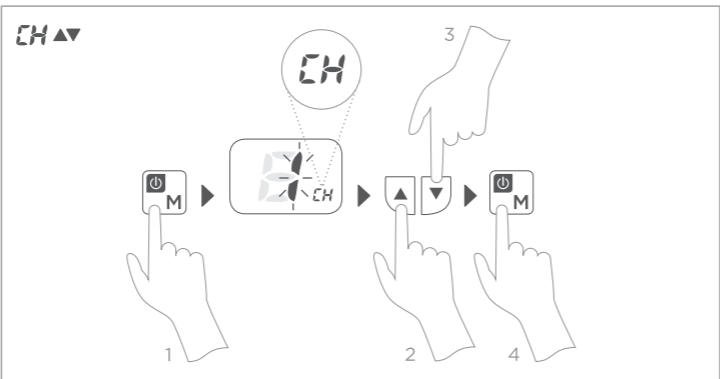

4. ADJUST VOLUME | 调节音量

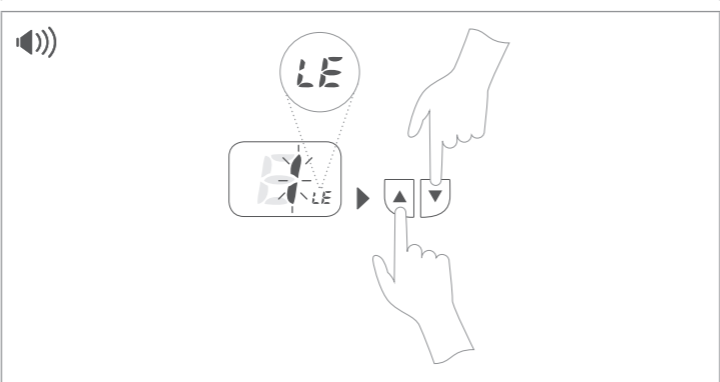

5. FUNCTION "CALL" | "呼叫"功能

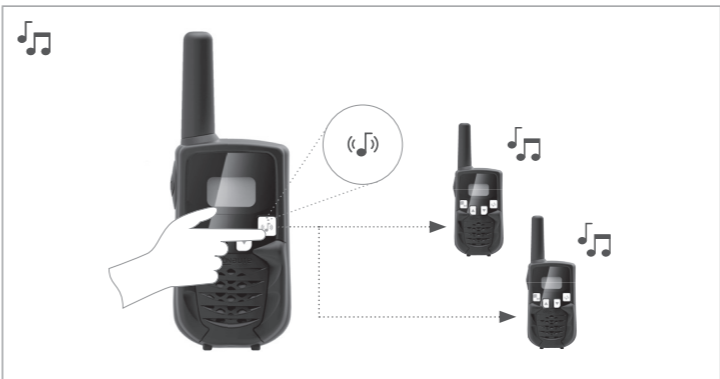

6. TALK | 讲话



可用频道: 20 个      输出功率 (TX): 0.5 W

CHANNEL 频道	FREQUENCY (MHZ) 调频 (MHZ)	CHANNEL 频道	FREQUENCY (MHZ) 调频 (MHZ)
1	409.75	11	409.875
2	409.7625	12	409.8875
3	409.775	13	409.9
4	409.7875	14	409.9125
5	409.8	15	409.925
6	409.8125	16	409.9375
7	409.825	17	409.95
8	409.8375	18	409.9625
9	409.85	19	409.975
10	409.8625	20	409.9875