

# **Camera X-snipe b'Twin 300**

## **Instruction leaflet**

Please read these instructions carefully before using this product and note where you store them so you can consult them later. The product images and illustrations shown are for illustrative purposes only. Please make reference to the real product. These user instructions are liable to change, without warning, in order that they might be improved.

# CONTENTS

<b>I</b>	Quick Start-up	-----	2
<b>II</b>	Use Precautions	-----	2
	• Waterproofness	-----	3
<b>III</b>	Technical Specifications	-----	4
<b>IV</b>	Minimum IT System Required	-----	4
<b>V</b>	Description de la camera	-----	5
<b>VI</b>	Description of the Camera Assembly	-----	6
<b>VII</b>	Use of the Camera	-----	7
	• Batteries and Recycling	-----	7
	• Turning on the Camera	-----	8
	• Inserting/Taking Out the SD Memory Card	-----	8
	• Recording a Video Sequence	-----	9
<b>VIII</b>	Settings Menu	-----	10
	• Resolution	-----	10
	• Quiet Mode	-----	11
	• Sound Recording	-----	11
	• Deleting a Video Sequence	-----	11
	• Setting the Date and Time	-----	11
	• SDMemory Card	-----	12
<b>IX</b>	Computer Connection	-----	13
<b>X</b>	Viewing a video sequence on a TV screen	-----	13
<b>XI</b>	Repair	-----	14

## **I) QUICK START-UP**

### **Turning on the Camera**

Keep pressing the On/Off button for 2 seconds (until you hear 2 beeps). The LCD screen displays the time remaining.

### **Record a video sequence**

1. Point the camera at the subject to film.
2. Press the video capture button to begin recording (the camera will make a beep). The time elapsed appears on the screen.
3. Press the video capture button again to stop recording (the camera will make two beeps). The length of the video sequence appears on the screen for 3 seconds, after which the time remaining is displayed (the time remaining is only an estimation)

## **II) NORMAL USE CONDITIONS**

This sport video camera is designed to record images of your sport activities on an SD card. With the help of multiple hanging systems, notably on a helmet or bike handlebars, it allows you to capture original views while keeping your hands free to practice sport.

### **PRECAUTIONS FOR CAMERA USE**

Read the following instructions carefully to be able to use your camera well.

- The X-Snipe bTwin camera 300 is not completely shockproof. Be careful not to drop it.
- For your safety, do not press the camera buttons while participating in sport activities.
- Do not store the camera in a damp, dusty place, if you do not expect to use it for a long time. This could cause a fire or an electric shock.
- Do not put the camera in a place where sudden temperature changes occur, and do not expose it to direct sunlight. This could damage the camera case and its internal components.
- Clean the lens with a blower brush, or wipe it with a soft cloth by making circular movements to remove the traces of fingerprints and dust.
- We recommend using lithium batteries or alkaline batteries at a temperature between 0°C and 40°C, to optimise the autonomy of your camera.
- Turn off the camera before taking out the batteries and memory card. The card and its contents may be damaged if it is inserted or taken out while the camera is turned on.
- Take out the batteries and memory card before storing the camera for a long period, and then place it in a well-ventilated place to prevent moisture from developing.
- Contact qualified service personnel, if:
  - a) the receptacle is damaged or worn out.
  - b) the device fell and/or the case has been damaged.
  - c) a liquid has penetrated the interior of the camera.

**Liability Limits:** Oxylane, B'twin or Geonaute cannot in any circumstance be held responsible for injuries and damages of any nature linked to the practice of sport or high-risk activities; the warranty only covers equipment and manufacturing defects.

**Author Rights:** The user is warned that by law, the transfer of files containing protected photos or data is only authorised for the author. The user of the camera assumes full responsibility for any violation of the law.

## **WATERPROOFNESS**

This X-Snipe 300 camera is waterproof up to 3m. B'Twin is not responsible if water penetrates the interior of the camera following improper use of the device by the operator.

### **To optimise the waterproofness of your camera**

#### **Stage 1:**

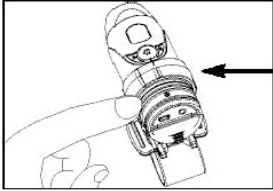

Apply the silicone grease (supplied) Remove the seal and use your fingers to apply a thin layer of silicone grease on its surface. The silicone grease must be applied uniformly.

#### **Step 2:**

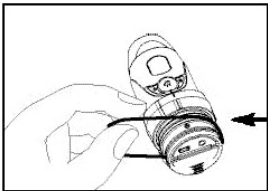

Add an extra seal for more protection

#### **Stage 3:**

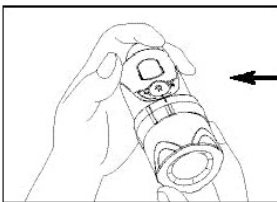

Replace the lid.

- Make sure the lid is closed. Water may penetrate the interior of the camera if the battery compartment is not properly closed.
- If the camera gets wet, quickly wipe it with a dry cloth.
- The other camera accessories are not waterproof.
- Make sure the seals are clean and that the silicone grease is applied before using the camera underwater or in a wet environment.

### **Using the camera in cold temperatures**

- We recommend that you insert "Energizer e2" lithium batteries in cold temperatures. Do not expose the camera to extreme temperatures likely to interfere with its proper functioning.

Likewise, Ni-MH rechargeable batteries are less sensitive to cold than alkaline batteries.

#### **Caution:**

- Do not try to recharge non-rechargeable batteries.
- Remove rechargeable batteries from the camera before recharging them.
- Rechargeable batteries must be recharged under strict adult surveillance.
- Do not short-circuit the power supply terminals.
- Remove the batteries from the device when they are worn out.

In every instance, the cold drains the camera battery life. Keep them at a moderate temperature as much as possible when you are not shooting.

### **III) TECHNICAL SPECIFICATIONS**

- CMOS sensor 640x480 VGA resolution
- 32 MB integrated memory
- SD memory card port for extension up to 4GB (not supplied)
- Video storage capacity:
  - 640 x 480 pixels (30 images per second)
  - 320 x 240 pixels (30 images per second)
- LCD 2-digit display of functions N/B on the case
- Focus: 1.5m to infinity
- AVI video format
- USB Port (1.1)
- Feature for choosing to erase everything or only the last video recorded
- Automatic stop after 10 minutes
- 2 AA alkaline batteries
- Dimensions: 40mm diam. x 110mm long
- Operating Systems: WIN 2000/XP/Vista/Seven and Apple Mac OS X 10.3/10.4

### **IV) MINIMUM IT SYSTEM REQUIRED**

- Pentium III 800 MHz or higher
- WIN 2000/XP/Vista/Seven and Apple Mac OS X 10.3/10.4
- Minimum of 128 MB of random access memory (RAM)
- 800 MB of disk space available
- SVGA 800 x 600 display (32 bit)
- Windows- compatible 16-bit card

\* In some cases, the number of images displayed per second may be automatically reduced to optimise memory sharing.

**V) DESCRIPTION OF THE CAMERA**

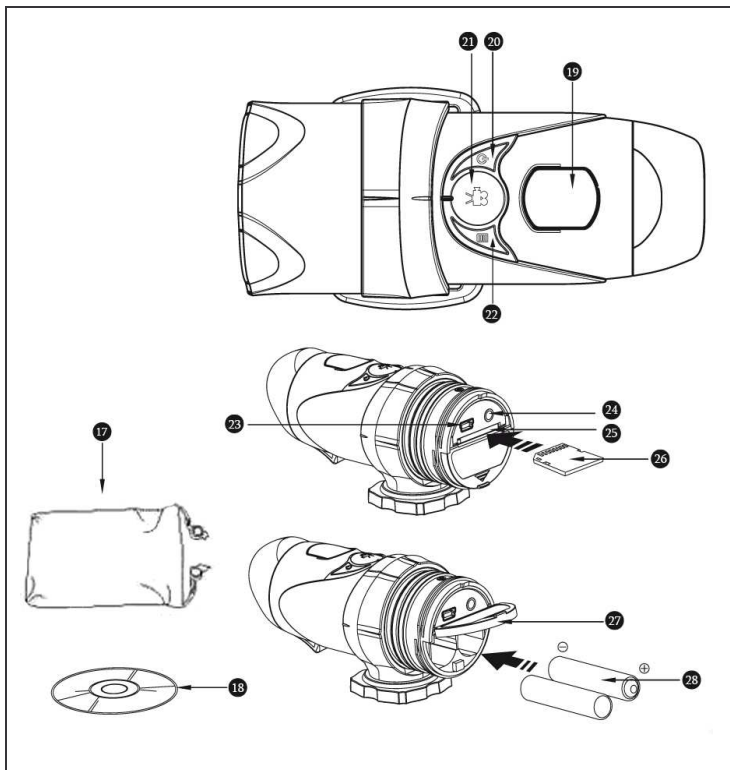
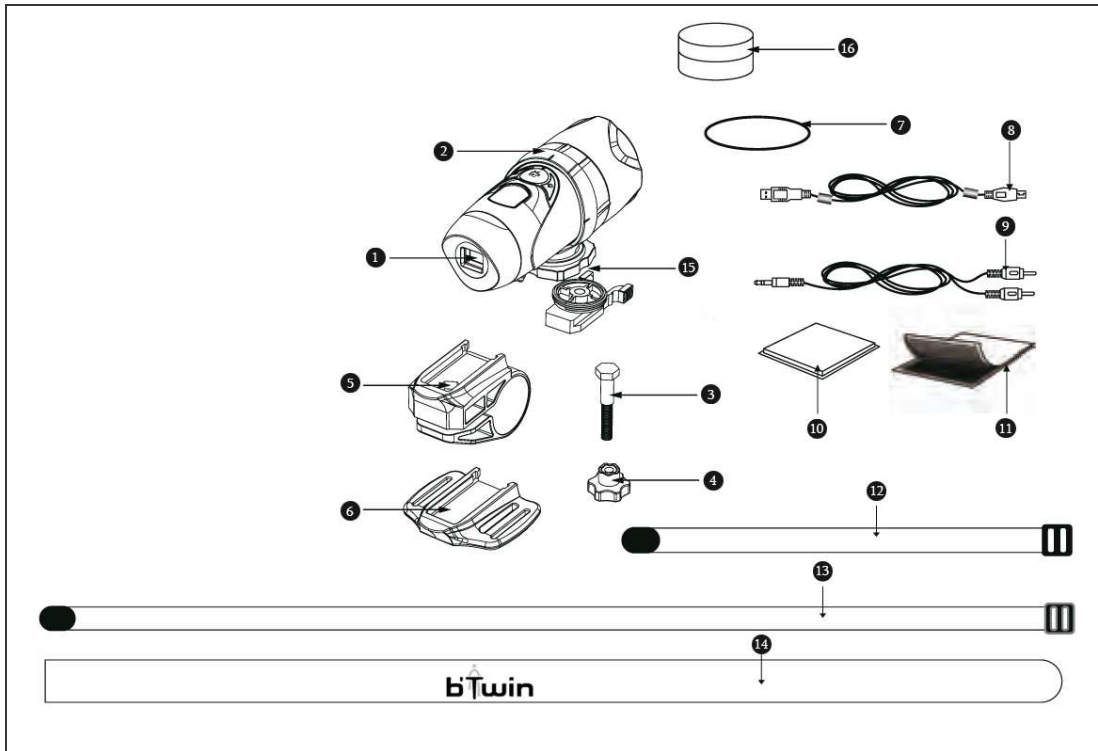

1. Aim
2. Fixation ring
3. Screw
4. Nut
5. Support for fixation to a bar
6. Base for fixation to a helmet
7. Seal
8. USB Cable
9. AV Cable
10. Rubber tarpaulin
11. Velcro patch
12. Short velcro tape
13. Long velcro tape
14. Rubber headband
15. Locking ring
16. Silicone grease
17. Carry bag
18. User manual CD
19. LCD Screen
20. Stop/Start button
21. Video Capture Button and Enter Button
22. Menu Button & Selection Button
23. USB Mini-port
24. AV Port
25. SD card slot
26. SD Card (Not supplied)
27. Battery compartment trapdoor piles
28. Batteries (included)

## **VI) DESCRIPTION OF CAMERA ASSEMBLY**

The camera can be assembled in different ways using the velcro tape and patch supplied. Please follow the assembly methods described below:

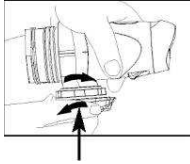

### **Position the camera.**

- a) Turn the camera counter-clockwise to screw it together.
- b) Turn the camera clockwise to unscrew it.

### **Mounting the camera on the helmet by using the silicone rubber headband.**

1. Stick the rubber patch on the back of the helmet fixation base.
- 2.+3. Draw the headband through the base.
4. Position the base on the helmet with the help of the headband.
5. Slide the camera in the base.
6. Adjust the camera angle and make sure it is securely positioned.

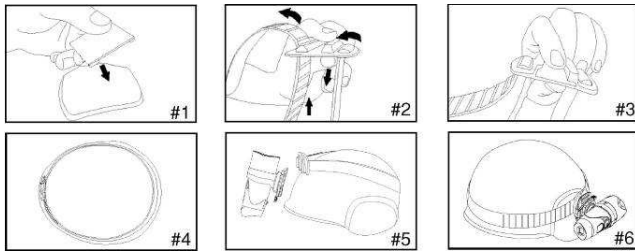

### **Mounting the camera by using the velcro tape:**

1. Stick the rubber patch on the back of the helmet fixation base.
- 2.+3. Install the base on the helmet, and draw the velcro tape through the base.
4. Firmly attach the velcro tape by drawing it through the holes of the helmet.
5. Slide the camera in the base, adjusting the camera angle and make sure it is securely positioned.

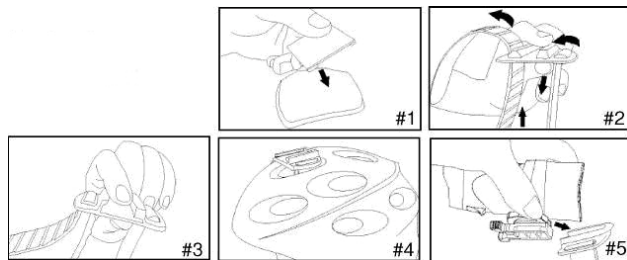

### **Mounting the camera by using the support for fixation to a bar:**

1. Install the support on the bar.
2. Add the screw and the nut to stabilise the support.
3. Slide the camera in the support and make sure it is securely positioned.
4. Adjust the camera angle.

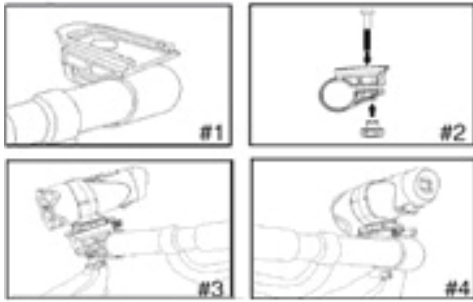

## **VII) USING THE CAMERA**

### **BATTERIES AND RECYCLING**

#### **Battery installation**

1. Unscrew the cover behind the device
2. Open the battery cover by sliding it to one side
3. Insert 6 AA-LR 1,5V alkaline batteries or Ni-MH AA-LR 1,2 V rechargeable batteries according to the polarity shown on the diagram and the battery cover
4. Replace the battery cover and firmly close the rear plastic cover

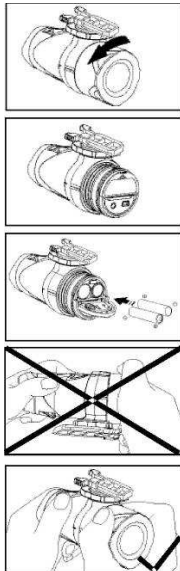

**Warning:** Change your video sequences in the PC before proceeding to replace the batteries. Otherwise, you may lose data. When the batteries are almost empty, the "battery icon" appears on The LCD screen. It is then time to download the videos on the PC and to replace the battery. Take out the batteries if the camera is not used for a long time. This prolongs their life.

NB: Replace both batteries at the same time, and do not mix old batteries with new ones. Do not mix alkaline batteries with rechargeable batteries. The USB cable cannot charge rechargeable batteries on the interior of the camera. They must be recharged separately by an external charger.



### TURNING ON THE CAMERA

Press on the Stop/Start button  for 2 seconds (until you hear 2 beeps). The LCD screen is turned on. For your safety, do not press any button on the camera while performing your sport activities.

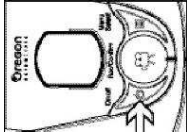

### TURNING OFF THE CAMERA

1. Press on the Stop/Start button  for 2 seconds (until you hear 2 beeps). The LCD screen is turned off.
2. If there are several minutes of inactivity, the camera is automatically turned off, except in USB mode.

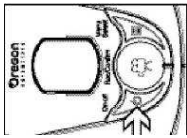

**NB:** If the camera is connected to your PC, you must disconnect the USB cable to turn it off.

**NB:** Make sure the camera is turned off when you insert or remove the SD memory card. The SD memory card and information it contains can be damaged if the card is inserted or taken out when the camera is on.

### INSERTING/REMOVING THE SD MEMORY CARD

#### To insert:

1. Turn off the camera .
2. Unscrew the cover located on the back of the device.
3. Insert the card completely in the slot ("upside down" with the metal contacts on the top).
4. Screw the cover back on.

#### To remove:

1. Turn off the camera .
2. Unscrew the cover located on the back of the device.
3. Push the card until you hear a click, and then remove it.
4. Screw the cover back on.

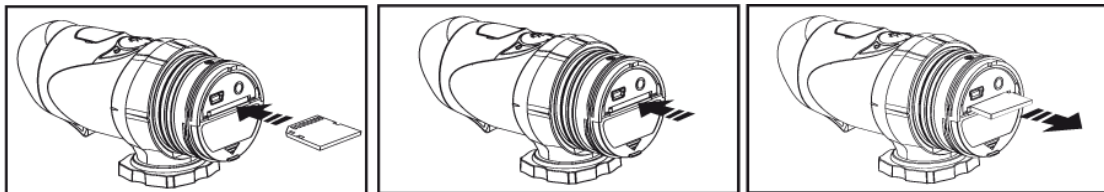

#### Nb:

- a. Make sure the card is inserted correctly.
- b. Do not touch the connection terminals behind the card.
- c. The card can be damaged if it is not inserted completely.
- d. The card and information it contains can be damaged if it is inserted or removed when the camera is on.



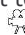

### RECORD A VIDEO SEQUENCE

**Warning:** As with all video cameras, the stability of the cameraman is a key element in the success of the film. Be sure not to move too much, not to move too quickly, not to film objects that are too close or too far away, nor to quickly change the focus distance. The focus will be clean from 1.5m to infinity.

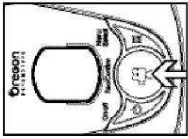
1. Point the camera at the subject to film.
2. Press the video capture button  to start recording (the camera will make a beep). The time elapsed appears on the screen.
3. Press the video capture button again . The length of the video sequence appears on the screen for 3 seconds, after which the time remaining is displayed (the time remaining is only an estimation).



FR

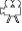





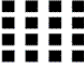

4. Press the Menu button  for 2 seconds to select a resolution (640 x 480, 320 x 240). Press the Menu button again  to move through the indicator icons at the top of  the LCD screen (see page 16). Then press Enter to confirm your selection: The icons then stop flashing.

**Nb:**

1. The default resolution is 640 x 480 (VGA).
2. When the time is displayed, 'H' indicates hour, 'M' indicates minute, and 'S' indicates second.
3. If the duration of the recording is long, the video file can be automatically split in two. After this operation, the camera then returns to the place where the recording was stopped. Note that the time the saving occurs depends on the size of the file.

## VIII) SETTINGS MENU

1. Press the Menu button  (the camera makes a beep) to begin choosing the options.

Icon	Title	Description
	High resolution (640x480 pixels)	Large video format
	Average resolution (320x240 pixels)	Less storage capacity Average size video format
	Quiet Mode	Button sounds are deactivated
	Bran	Sound recording
	Deleting the last video sequence	Erase the last video sequence recorded
	Deleting all video sequences	Erase all video sequences stored on the camera or on the SD memory card
	Date and Time	Set the date and time
	30 images per second	The number of images displayed is 30 per second
	Weak batteries	The batteries are weak
	SD memory card	The SD memory card is inserted in the camera

2. You can switch to different shooting modes by pressing several times on the Menu button . Each mode is then displayed on the LCD screen.

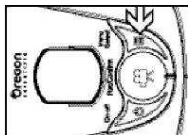

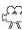
3. Press on the Enter button  to confirm the selection (the camera makes two beeps).

4. To exit selection mode, press the Menu button several times , until the icon selected stops flashing.



Press the Menu button

### 8.1. RESOLUTION

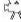

a) This camera allows you to choose between two resolutions:

640 x 480 and 320 x 240 pixels. The sequences in high-resolution are the best quality because they contain the most pixels (smaller unit which compose an image), while those in low-resolution have less but allow you to film for a longer time. Thus, the duration of a video sequence depends on the resolution chosen. To select a resolution, press the Menu button  until the LCD screen displays the corresponding icon. Then press the Enter button  to confirm your selection.

Mode	Image size	fps
VGA	640 X 480 pixels	30
QVGA	320 X 240 pixels	30

### 8.2 QUIET MODE

This mode allows the user to deactivate all sounds.

The icon **P** flashes and the current mode is not displayed. Press the Menu button  to switch to the following mode or press the Enter button  to select Quiet Mode.



Once inside, **P** it continues to flash and ON is displayed on the screen. If you choose , the sound is deactivated, but audio can be recorded. If you choose OFF, the sound is activated.

To alternate from ON to OFF, press 'Menu', and then select one of the two options.

### 8.3. RECORDING SOUND

After having chosen this mode, 'LO' is displayed on the screen.



'LO' means sound is recorded during shooting.

Press the Menu button  (the camera will make a beep) to deactivate the microphone: The word 'OFF' is displayed. Press the Menu button  to go back to 'HI' mode. Then press the Enter button  (the camera will make two beeps) to confirm the setting and move to the following icon.



**Warning :** the microphone of the X-Snipe 300 is protected against splattering. It is intended for recording background noise and not a directional sound (voice). The sound volume, because of the waterproofing of the product, will be too weak to record a conversation.



### 8.4. DELETING A VIDEO SEQUENCE

To delete a video sequence stored in your camera, press the Menu button  until the LCD screen is displayed . Press the Enter button  to confirm the deletion.

Repeat these two operations to individually delete the video files.

Nb: After deleting a video file, the LCD screen corrects the number of files remaining.



#### Deleting all video sequences

To delete all the video sequences stored in your camera, press the Menu button  until the LCD screen is displayed .

Press the Enter button  to confirm the deletion.



Nb: Deleting several video files can take several minutes.

### 8.5 SETTING THE DATE AND TIME (CLOCK)

Position yourself on the Date icon in Menu mode by pressing the Menu button several times . When the Date icon flashes, press the Enter button  to change the date and time.

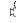

#### Setting the year

1. Press the Menu button  to adjust the last digit of the year (2000-2009). Press the Enter button to confirm it.
2. Press the Menu button  to adjust the third digit of the year (20X0-20X9). Press the Enter button  to confirm it and go on to set the month.

### Setting the month

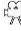
The letter "M" is displayed for setting the month. Press the Menu button  to select the month. Press the Enter button  to confirm and go on to set the day.

### Setting the day

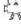
The letter "D" is displayed for setting the day. Press the button  to set the day. Press the Enter button  to confirm and go on to set the hour.

### Setting the hour

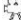
The letter "H" is displayed for setting the hour. Press the button  to set the hour. Press the Enter button  to confirm and also to be able to set the minutes.

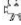

The letter "M" is displayed for setting the minutes. Press the button  to set the minutes. Press the Enter button  to confirm and also to be able to exit the menu.

## 8.6. SD MEMORY CARD

On this device, you can use SD memory cards with a capacity of up to 4 GB. To use an SD memory card, turn off the camera and insert the card. When the camera is turned back on, the card icon, as well as the time remaining, will be displayed on the LCD screen. All new video sequences captured will be saved on the card.

### Nb:

1. If there is an error involving the SD memory card, the card icon and the letters 'Err' will be displayed on the LCD screen. In this case, turn off the camera and remove the card.
2. The SD memory card is equipped with an overwrite protection device to prevent accidental loss of data. The letters 'Err' will be displayed if the SD memory card device is locked in protection mode.
3. We recommend that you use the regular 'ScanDisk' SD memory cards or AData SD cards.

### Recording time available

The recording time available is an estimation, which can vary according to the recording conditions and the card types.

Setting the image quality		VGA 30 ips	QVGA 30 ips
Internal memory	32 MB	51 s	1min 36s
SD memory card	1 GB	30min	57 mn
	2 GB	60 mn	114 mn
	4 GB	120 mn	216 mn

## **IX) CONNECTION TO A COMPUTER**

You can access recorded video sequences from a PC by connecting the camera to the PC, using a USB cable.

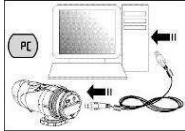

1. Turn on the camera.
2. Use the USB cable to connect the camera to the PC.



3. There are two modes available: "F" and "C". The first mode allows you to see the files saved on the camera or the SD memory card. The second mode activates the webcam function.

**Warning:** This "webcam" function is not available on this product. Thus, you must use the "F" option.









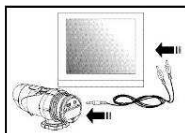

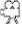
4. "F" is displayed on the LCD screen, indicating the camera is connected to your PC and you can access the saved files.
  5. To review the files on the camera or the SD memory card, press the Enter button , after which the camera icon appears in the Workstation folder.
- \*If you connect the camera to a PC for the first time, the driver required is automatically installed, which allows the camera to be recognised by the Windows system. The '100ATC3K' folder then appears in the Workstation folder.
6. Open the '100ATC3K' folder in the [DCIM] folder to begin selecting the sequences. Copy those you would like onto your PC.

- Composition of the '100ATC3K' folder

Removable disk	DCIM	100ATC3K
• Internal memory		
• SD memory card		AVI_0001. avi
		AVI_0002. avi
		AVI_9999. avi

## **X) VIEWING A VIDEO SEQUENCE ON A TV SCREEN**

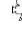

1. Turn off the camera and the TV.
2. Connect the camera to the TV by using the AV cable.
3. Turn on the TV and the camera.
4. There are two modes available: PB (playback mode) and VF (viewfinder mode).
5. PB is the default mode. To switch to VF mode, press the Menu button  and then press Enter . Once this mode is selected, a real time image is displayed on your TV screen (or PMP). In VF mode, all the recording functions are deactivated. The VF mode is automatically activated when the AV cable connects the camera to the TV.
6. In PB mode, the principal functions are displayed on the TV screen. The principal functions include 'Pause' , 'Stop' , 'Return' , 'Play' , 'Fast forward' , and 'Delete a file' .
7. Press the Menu button  to move the cursor from one function to another.
8. Press the Enter button  when the function is selected.
9. To delete a file, select the 'Delete a file' icon and confirm it by pressing the Enter button .
10. To switch from one mode to another after confirmation, you must disconnect the AV cable and then reconnect it. Repeat steps 1-4.

## **XI) FREQUENTLY ASKED QUESTIONS**

Before contacting our hotline, please carry out the following checks:

### **Nothing is displayed**

- Are the batteries installed?
- Do the batteries need to be replaced?

### **After having connected the camera to the PC, the camera icon does not appear in the Workstation folder.**

-Make sure the ends of the USB cable are properly plugged in. -Make sure the USB port is working correctly. Connect another device to the USB port. If the other device does not work, it could be that the USB port is not working properly. In this case, contact the manufacturer.

### **I cannot record a video sequence**

- Make sure the camera or the SD memory card has sufficient space available. The time remaining is displayed on the LCD screen.
- Make sure the SD memory card is not locked. The letters "Err" are displayed when the SD memory card is locked.

### **The time remaining is not correct.**

-The time remaining is not always correct because it's an estimation. The time remaining does not only depend on the time recorded, but also the colour density of the video sequence. For a high-contrast image, such as outside, the time remaining is shorter than for a low-contrast image, like indoors.

### **It is impossible to view a video sequence on the TV screen**

-Make sure the AV cable ends are properly connected to the camera and the TV. -Make sure the camera is turned on.

### **Certain video sequences are only displayed when the SD memory card is inserted.**

- Video sequences can be stored on the internal memory. Connect the camera to the PC without inserting the SD memory card to display the files contained in the internal memory.

### **Contact us**

So that we continue to develop improved products which meet your needs, we shall be pleased to receive your feedback with regard to the quality, functionality and usage of our products: [www.btwin.com](http://www.btwin.com)

## Recycling

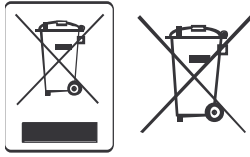

The "crossed-out bin" symbol indicates that this product and the batteries it contains cannot be thrown away with household waste. They must be separated and recycled specially. Take the batteries and unusable electronic products to an authorised collection area for recycling. Recycling your electronic waste in this way will protect the environment and your health.

### Limited Warranty

OXYLANE guarantees the initial purchaser of this product that it is free of equipment- or manufacturing-related defects linked to a period of two years from the purchase date. Please keep your receipt as proof of purchase.

- This guarantee does not cover damage resulting from misuse, from a failure to respect the precautions for use, from accidents, from improper maintenance or from commercial use.
- This guarantee does not cover damage caused by repairs made by people not authorised by OXYLANE.
- The guarantees contained herein explicitly replace all other guarantees including the implicit guarantee of merchantability and/or suitability for use.

OXYLANE will not be held responsible in any case for any damages, direct or indirect, of a general or specific nature, caused by or related to the use of this user manual or the products described in it.

- During the warranty period, the item will either be repaired free of charge by an authorised repair service or replaced free of charge (depending on the distributor).
- The warranty does not cover batteries or cracked or broken casings where signs of a blow are evident.

### INFORMATION CONCERNING THE FCC

This camera complies with section 15 of the FCC Regulation. Operation is subject to the following two conditions:

- 1 This camera has no risk of producing harmful interference.
- 2 This camera must accept all interference which occurs, including those which risk producing an undesirable functioning.

This equipment has been tested and shown to comply with the limits of class B digital devices, complying with the regulations in Section 15 of the FCC rules. Those limitations are imposed to ensure reasonable protection against intrusive interference within a residential installation. This equipment generates, uses and emits radio energy frequencies and, if it has not been installed in accordance with the instructions, could provoke harmful interference to radio communications. However, there is no guarantee that it will produce no interference in any particular installation. If this equipment provokes harmful interference for the radio or television reception, interference can be determined by turning off the device and then turning it back on, and it is recommended that the user remedy these interferences by applying one or several of the following measures:

- Reorientate or move the reception antenna.
- Increase the distance between the apparatus and the receiver.
- Plug the equipment into a circuit of a different current than the one the receptor is plugged into.
- Seek advice from the vendor or from a radio/television technician.

**Warning:** Any change or modification not expressly approved by OXYLANE is likely to declare void the user's authorisation to use the equipment.

### CE COMPLIANCE DECLARATION

OXYLANE hereby declares that the Camera X-snipe b'Twin 300 device conforms to the essential standards and other pertinent measures of the 2004/108/CE directive.

You have the right to request the certification documents from the service client of OXYLANE.

### NB

- This device passed the EN60065:2002 trial for vibration-resistance.
- This device meets the JIS7 waterproof standards.